

## Easy and quick installation

Panespol permits an easy, clean, and quick installation. It can be fixed to any surface without using adhesives or derivatives, which saves both time and money. Follow these simple step-by-step instructions for the above mentioned products.

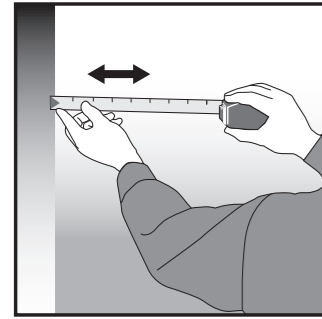

**1.** Measure the surface to be covered and calculate the number of panels needed.

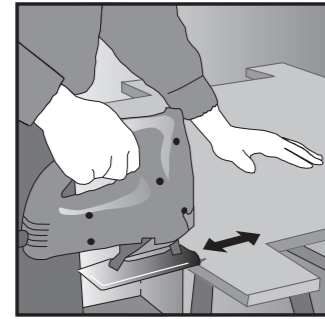

**2.** When starting the work, cut one side of the panel to get a completely straight edge.

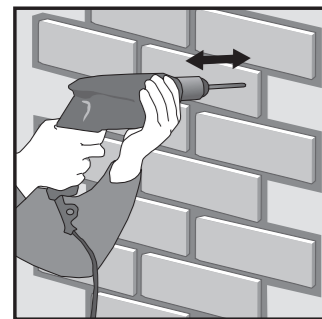

**3.** Fit the panel to the wall and drill through the panel directly into the wall using a 6mm drill bit. Put the screw into the wall-plug and introduce both into the hole in the panel. Push and screw them in until the panel is securely fixed (e.g. "Fisher" 6mm wall plugs and 4,5 x 40 screws are recommended). Use as many screws per panel as are needed.

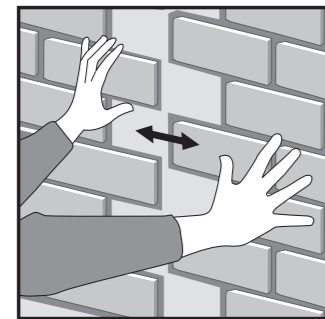

**4.** Repeat this procedure with the other panels which are designed to fit perfectly with their neighbor.

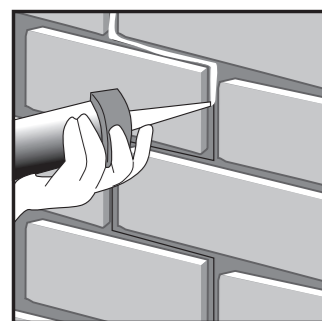

**5.** Once the whole wall has been covered with panels fill the joints and screw holes with glue-paste.

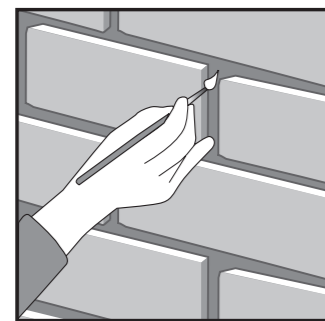

**6.** When filled, remove any irregularities in the paste with a fine brush. Once the paste is completely dry (approx. 24 hours), paint the joints and screw-holes with Panespol special paint, to give a perfect finish.

## Corner fixing

For external corners and pillars the panels need to be cut at an angle by following the steps shown.

When you reach an external corner, mark on the inside of the panel a line where the panel meets the wall. (This will be the inside line of the cut)



**B.** From this line, mark a parallel line away from the wall at a distance equal to double the thickness of the panel - between 2 and 4 cm depending on the model. (This will be the outside line of the cut)

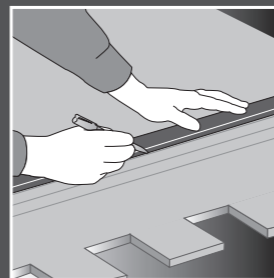

**C.** Set a jigsaw to 45° and use it to cut between the lines.

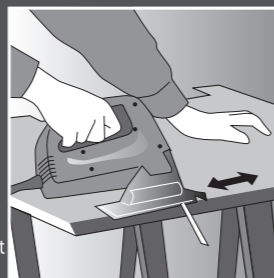

**D.** Offer the panel up to the corner and fix it to the wall, fill the joint and the holes.

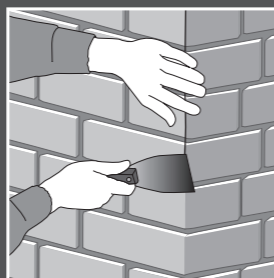

**E.** When the joint is filled, remove any irregularities in the paste with a fine brush.

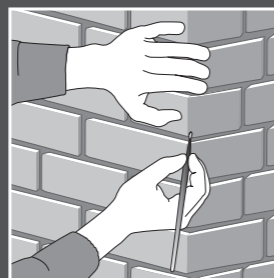

**F.** Once the filler paste is dry, paint the joint with Panespol special paint. Finish off by applying Panespol's ferrous oxide coating to give a perfect result.

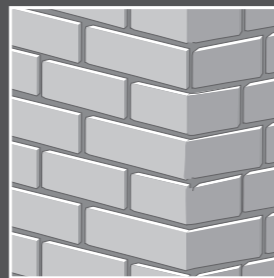

## Einfache und schnelle Installation

Panespol erlaubt eine einfache, saubere und schnelle Installation. Sie können jede Oberfläche verkleiden, ohne dabei auf Zement oder ähnliche Produkte zurückgreifen zu müssen, was Ersparnisse sowohl bei Material als auch bei Handwerkerkosten bedeutet. Im Folgenden werden die Arbeitsschritte für die Montage der oben genannten Modelle beschrieben.

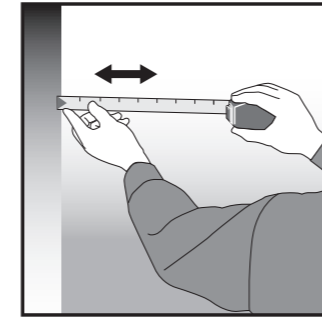

**1.** Wir vermessen die zu verkleidende Oberfläche und kalkulieren die Zahl der notwendigen Paneele.

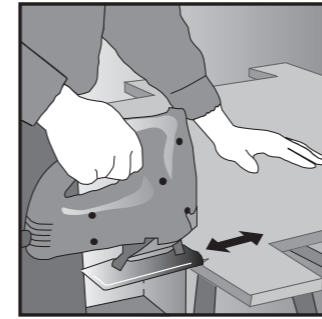

**2.** Zu Beginn der Arbeit schneiden wir eine Seite des Aufbaus zurecht, um so eine gerade Paneeleoberfläche zu erhalten.

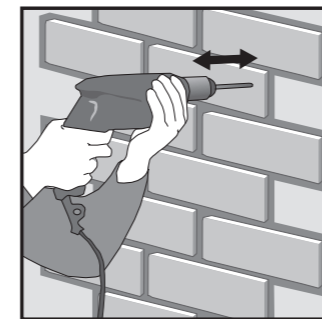

**3.** Wir halten das Paneel an die Wand und bohren gleichzeitig in Paneel und Wand ein Loch (Bohrergröße 6 mm). Anschließend schrauben wir das Paneel fest, bis die Schraube perfekt im Dübel eingesenkt ist (z.B. Dübel vom Typ "Fisher" von 6 mm und Schrauben von 4,5 x 40 mm). Es werden so viele Schrauben pro Paneel verwendet wie notwendig.

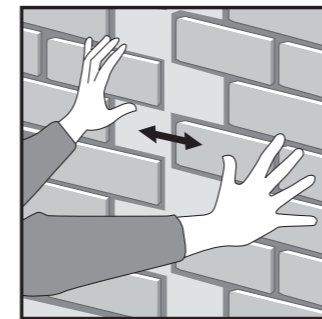

**4.** Wir setzen die Montage der Paneele fort, die auf Grund ihres Designs optimal eingepasst werden können.

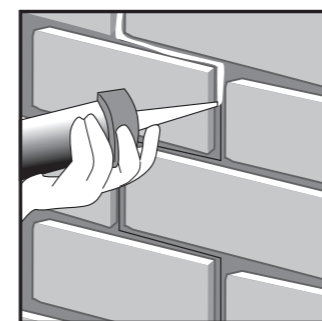

**5.** Ist die gesamte Oberfläche verkleidet, werden sowohl die Fugen als auch die Bohrlöcher mit Dichtungsmasse ausgefüllt.

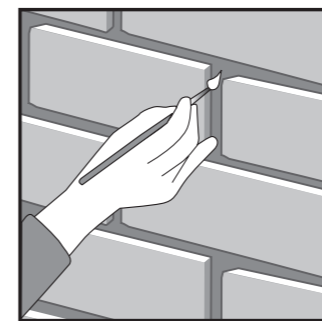

**6.** Sobald alles abgedichtet ist, beseitigen wir mit Hilfe eines feinen Pinsels mögliche Unebenheiten in Fugen und Löchern. Sobald die Dichtungsmasse absolut trocken ist (ca. 24 Std.), streichen wir Fugen und/oder Löcher mit Panespol-Fugenfarbe, um so ein tadelloses Endergebnis zu erzielen.

## Eckmontage

Bei Ecken und Pfeilern muss stets mit Winkelverbindung gearbeitet werden, wie im Folgenden beschrieben:



**A.** Gelangen wir bei der Verlegung an eine Ecke, markieren wir auf dem Panel die zu verwinkelnde Linie.

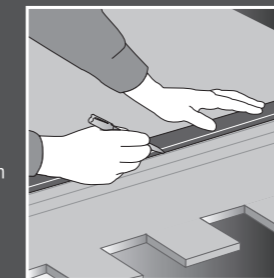

**B.** Zu dieser Linie ziehen wir in einem Abstand, der der doppelten Paneeldicke entspricht, eine Parallellinie (zwischen 2 und 4 cm, je nach Modell).

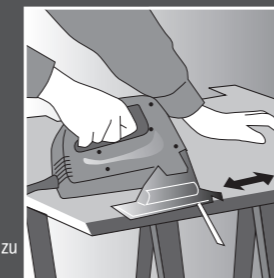

**C.** Mit der Dekupiersäge wird in 45° zu den Linien gesägt.

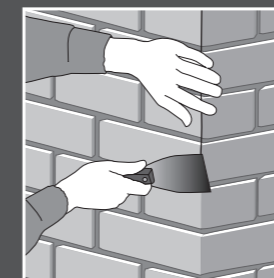

**D.** Ist das Paneel an der Ecke verwinkelt, füllen wir die Fugen vollständig aus.

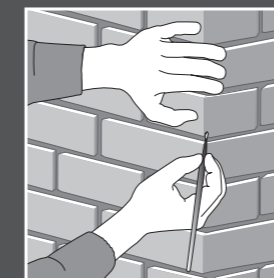

**E.** Sind die Fugen gefüllt, beseitigen wir mit Hilfe eines feinen Pinsels letzte Unebenheiten in der Dichtungsmasse.

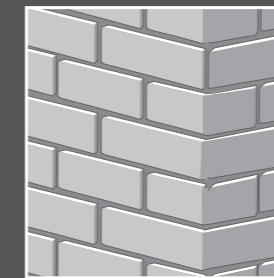

**F.** Sobald die Masse trocken ist, streichen wir die Fugen mit PANESPOL-Ausbesserungsfarbe. Zum Abschluss verwenden wir PANESPOL-Spezial-Erdfarben für ein tadelloses Endergebnis.

## Facile e veloce da montare

Panespol è facile e veloce da montare e non sporca. Potrà ricoprire qualsiasi superficie senza dover utilizzare cemento o derivati e risparmiando denaro in materiale e mano d'opera. I passi da seguire indicati sono validi per il montaggio dei modelli elencati in alto.

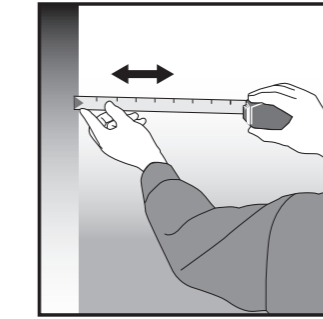

**1.** Misurare la superficie da ricoprire e calcolare il numero di pannelli necessari.

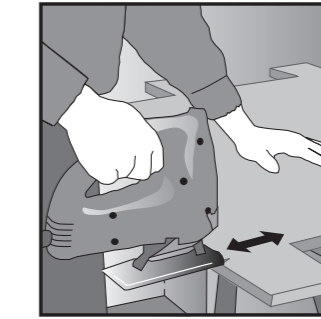

**2.** Prima di iniziare a lavorare, tagliare un'estremità dell'assemblaggio per ottenere un pannello dalla superficie retta.

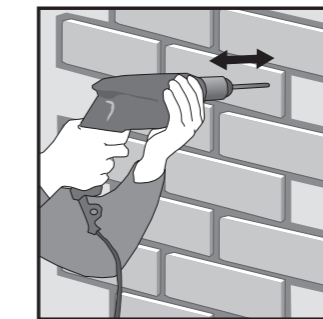

**3.** Porre il pannello sulla parete e trapanare contemporaneamente la parete e il pannello (mandrino di 6 mm). Successivamente, avvitare fino ad accoccare le viti (cuneo tipo "Fisher" di 6 mm e viti di 4,5 x 40 mm). Usare tutte le viti necessarie per ogni pannello.

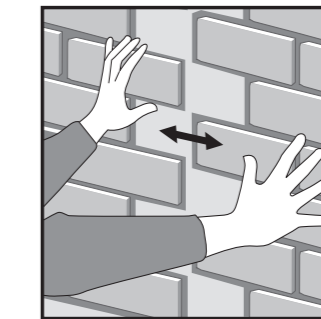

**4.** Assemblare i pannelli facendoli incastrare perfettamente.

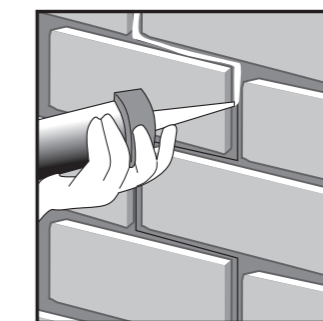

**5.** Dopo aver rivestito tutta la superficie, coprire con stuccatura i giunti dell'assemblaggio e i buchi del trapano.

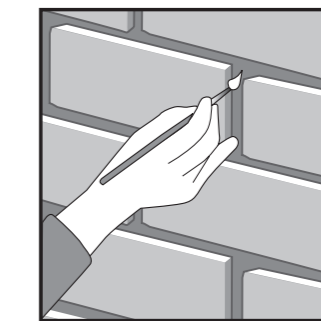

**6.** Dopo la stuccatura, passare un pennellino sottile all'interno dei giunti e dei buchi per livellare le irregolarità di altezza provocate dalla stuccatura. Fare asciugare bene (circa 24 ore) e, con la vernice per giunture Panespol, pitturare i giunti e/o buchi fino ad ottenere un risultato finale perfetto.

## Montaggio degli angoli

Per gli angoli e i pilastri si consiglia di lavorare a squadra e seguire le indicazioni seguenti:

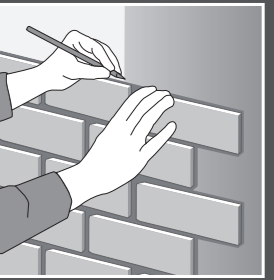

**A.** Quando durante il lavoro di rivestimento si giunge all'angolo, tracciare sul pannello la linea da piegare "a squadra" (45°).

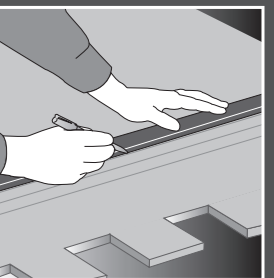

**B.** Partendo da questa linea tracciarne una parallela ad una distanza doppia rispetto allo spessore del pannello (da 2 a 4 cm, in base al modello).

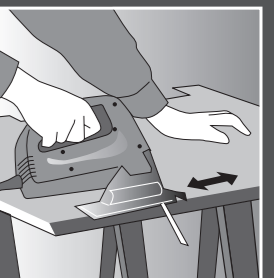

**C.** Con la sega, tagliare lungo le linee ad un'inclinazione di 45°.

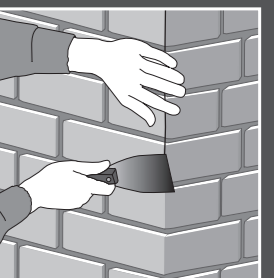

**D.** Porre il pannello a squadra lungo l'angolo, sistemare bene il giunto.

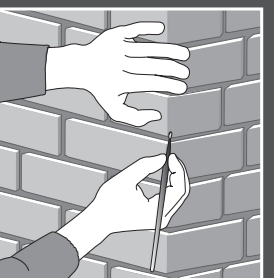

**E.** Dopo aver stuccato il giunto, passare un pennello sottile per livellare le irregolarità di altezza dello stucco.

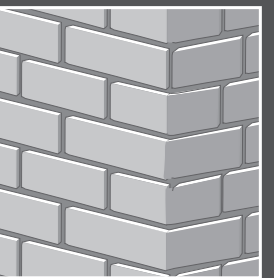

**F.** Fare asciugare lo stucco e verniciare le giunture con la vernice per ritocchi PANESPOL. Infine, ritoccare con polvere speciale PANESPOL per ottenere un impeccabile risultato finale.